

WORKIN'TIP 07/ CRISTINA FOGLIA RACCONTO DEL PROGETTO IL DISEGNO IN TRE DIMENSIONI

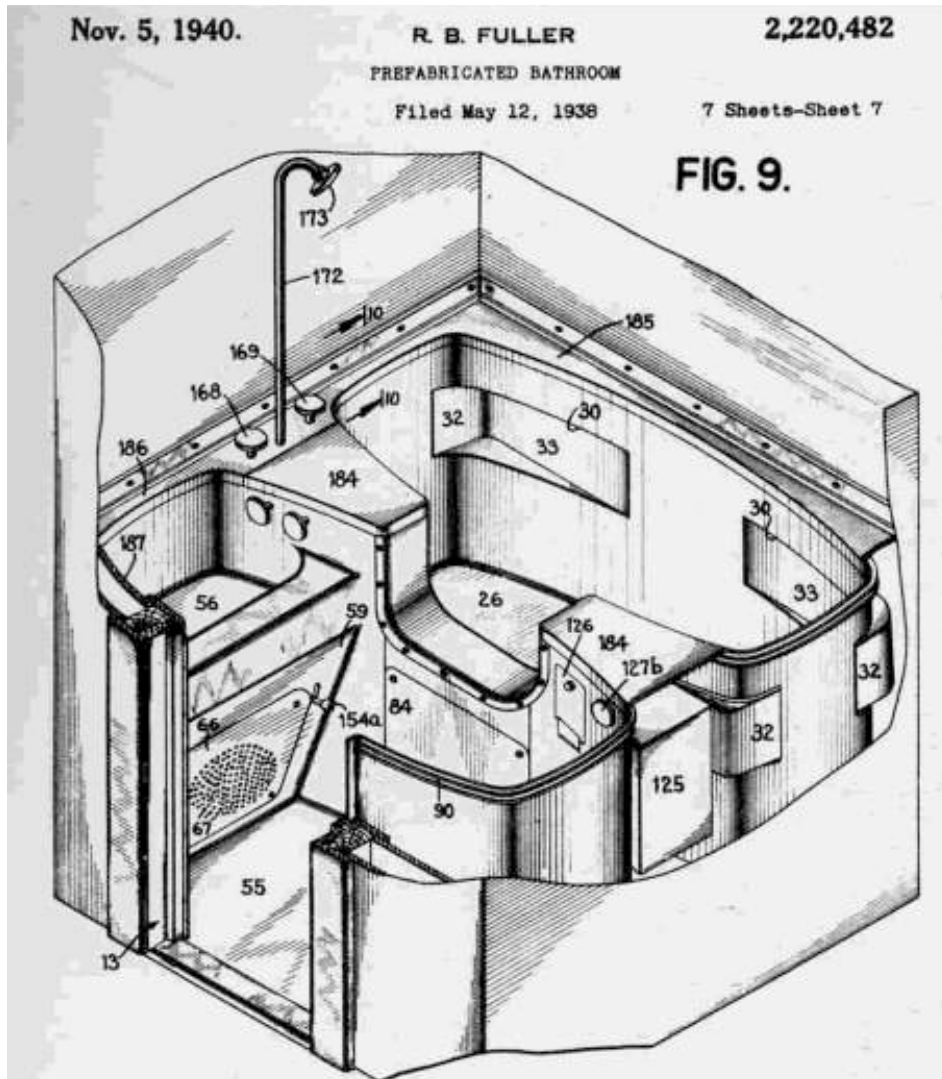

09 GIUGNO 2011
H 14.30

SCUOLA DEL DESIGN
POLITECNICO DI MILANO/BOVISA
LABORATORIO DESIGN DEGLI INTERNI 2.L| sez.I3

MODELLO 3D/ PER RACCONTARE LE COMPONENTI DI UN PROGETTO

CELLULA C

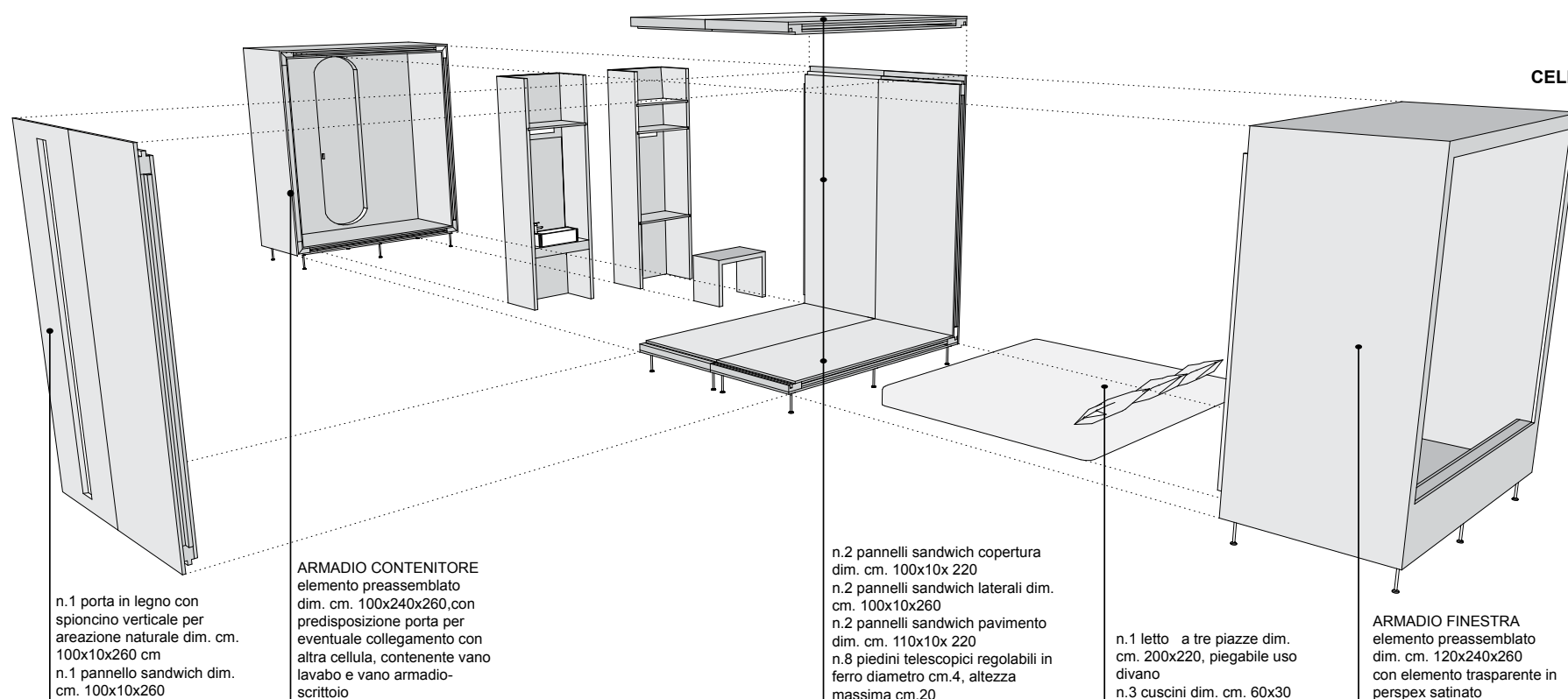

MODELLO 3D/ PER RACCONTARE UN PROCESSO

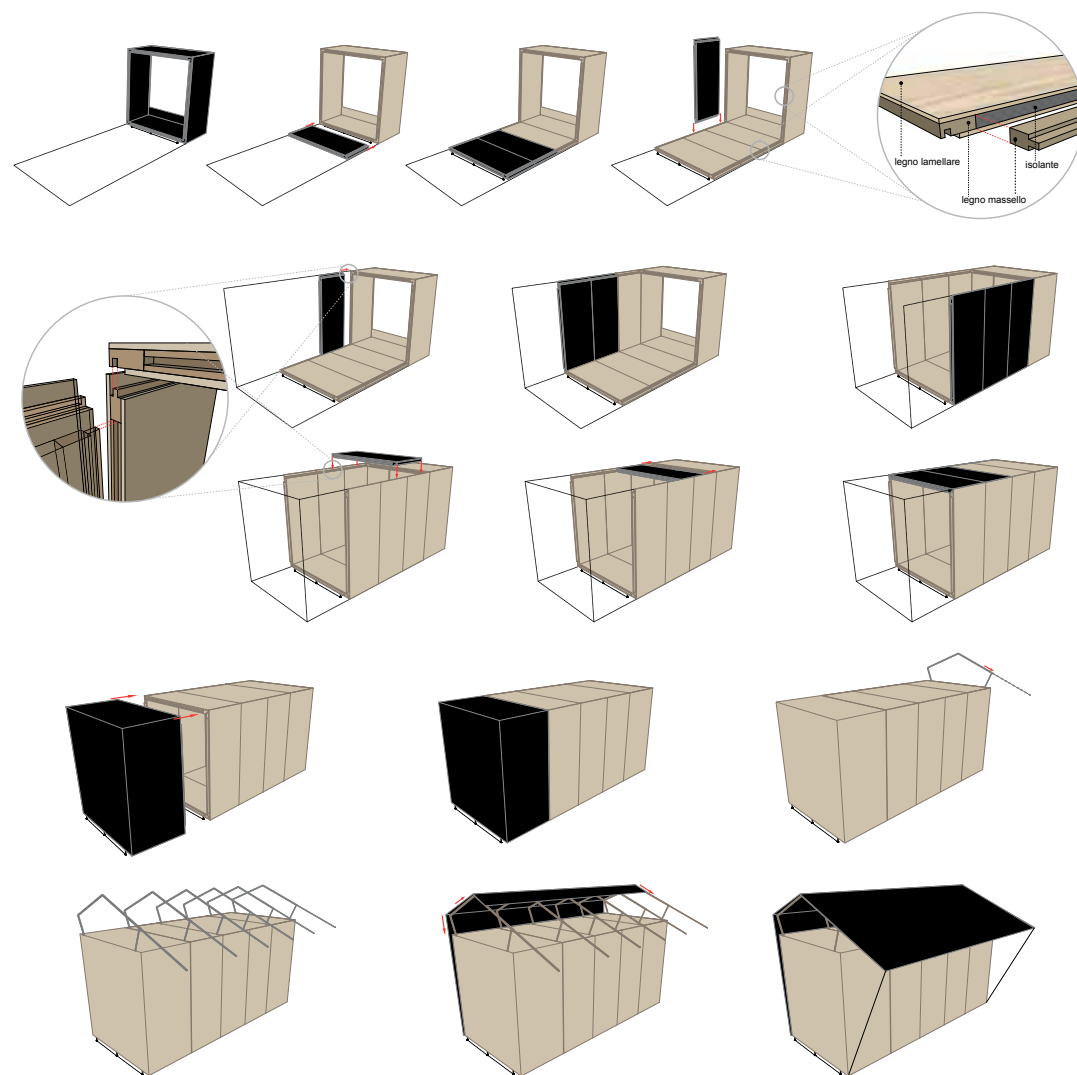
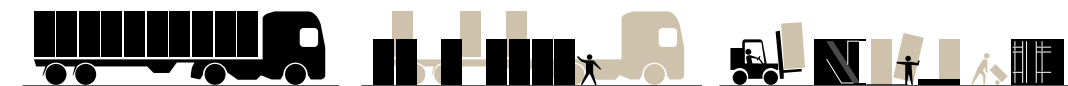

MODELLO 3D/ PER RACCONTARE UN PROCESSO

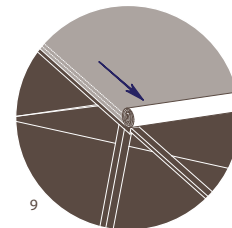
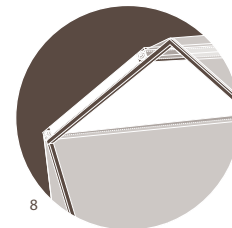
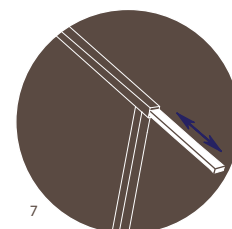
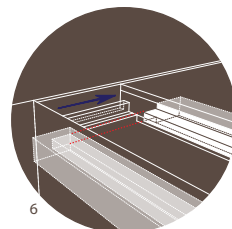
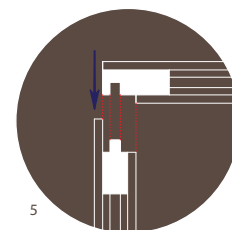
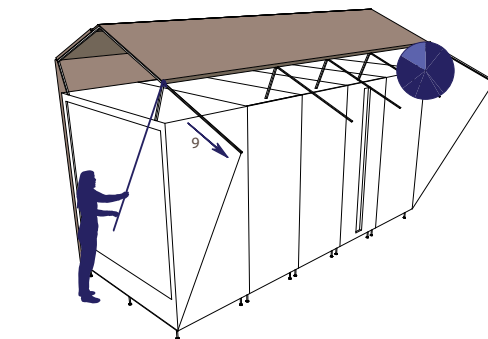
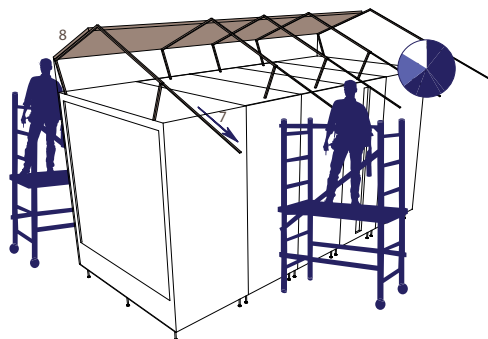
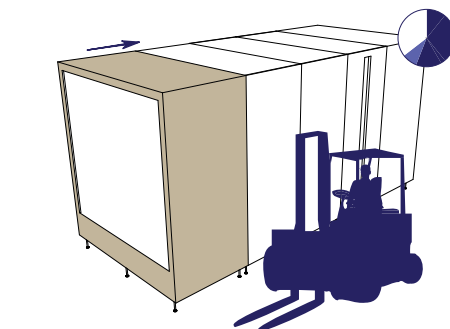
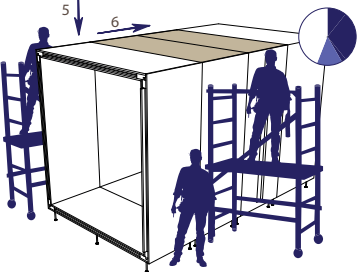
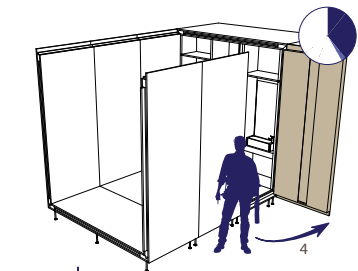
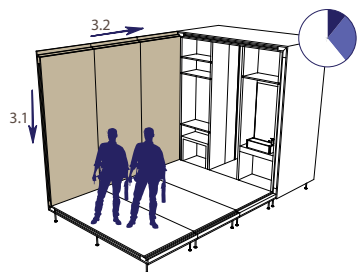
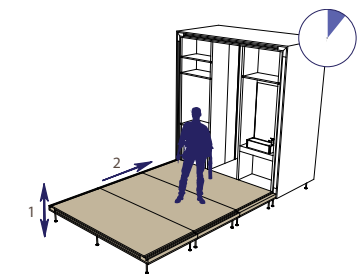
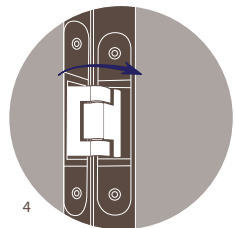
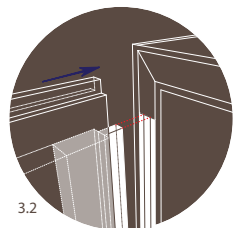
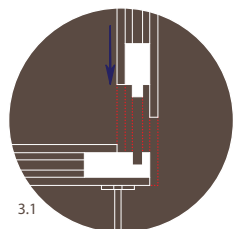
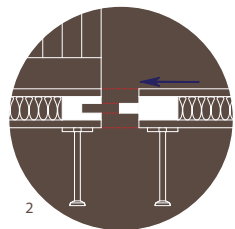
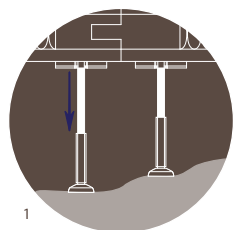

MODELLO 3D/ PER RACCONTARE I DETTAGLI

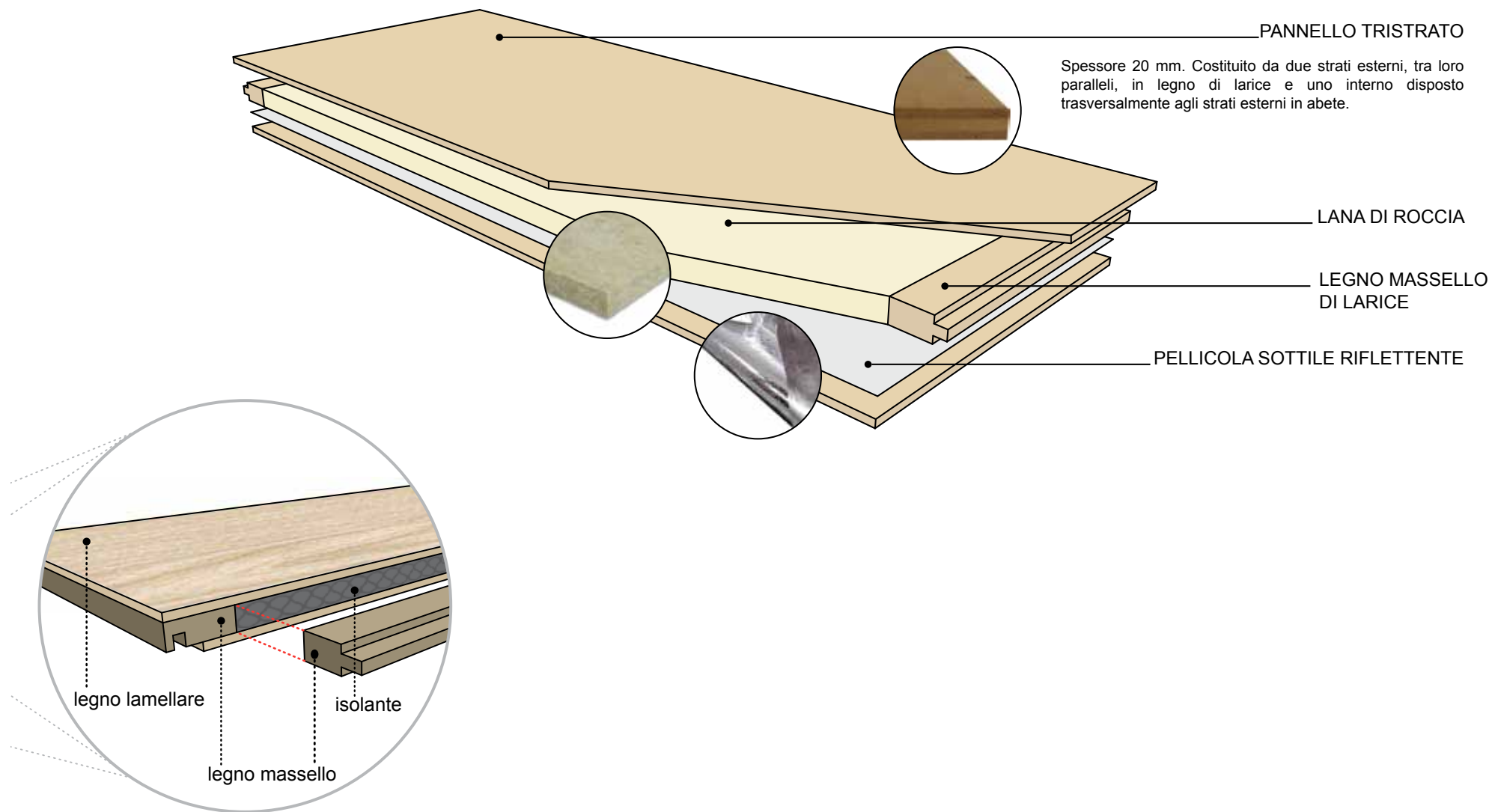

MODELLO 3D/
**PER RACCONTARE
LO SPAZIO**

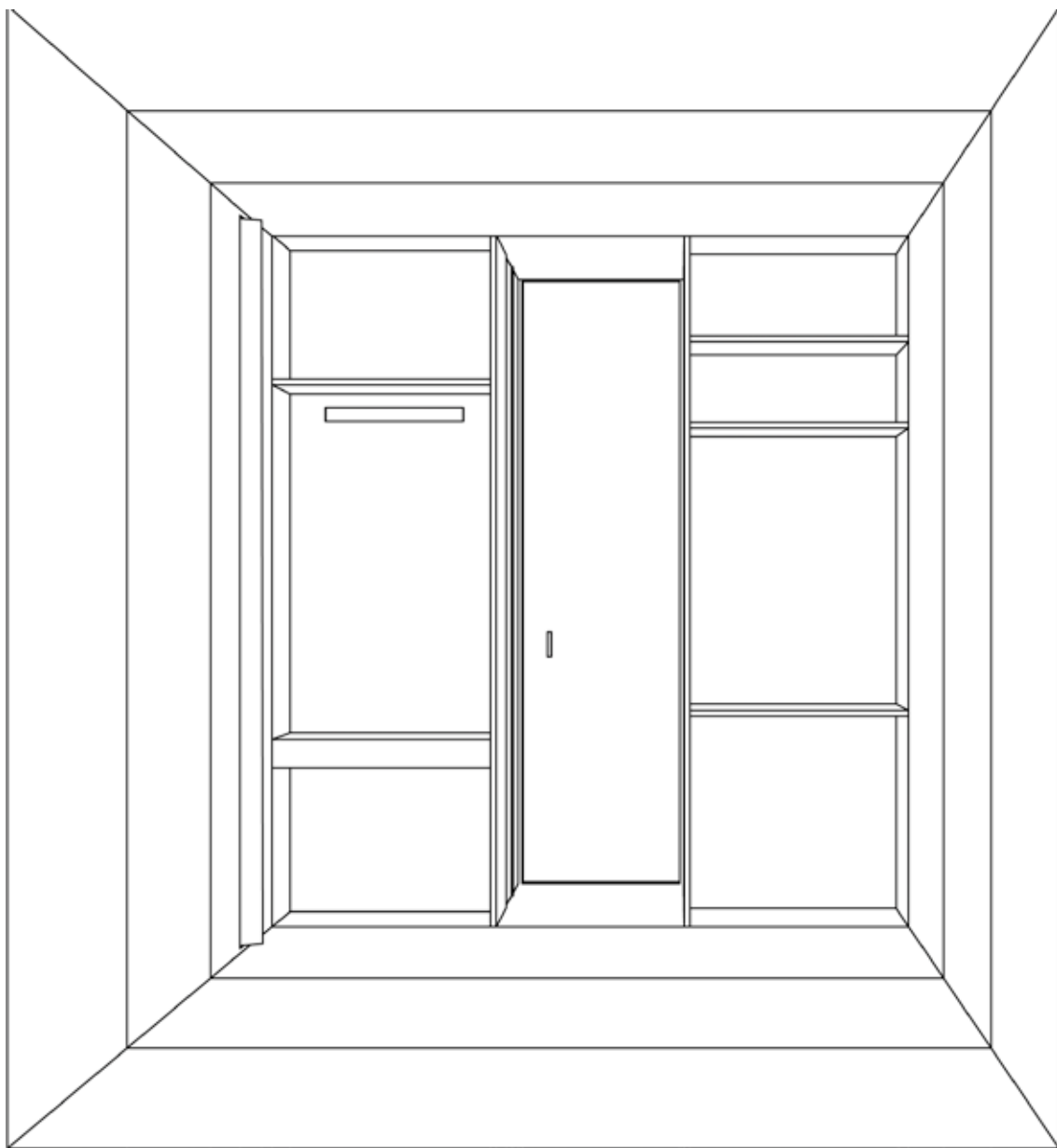

**MODELLO 3D/
PER RACCONTARE
LO SPAZIO**

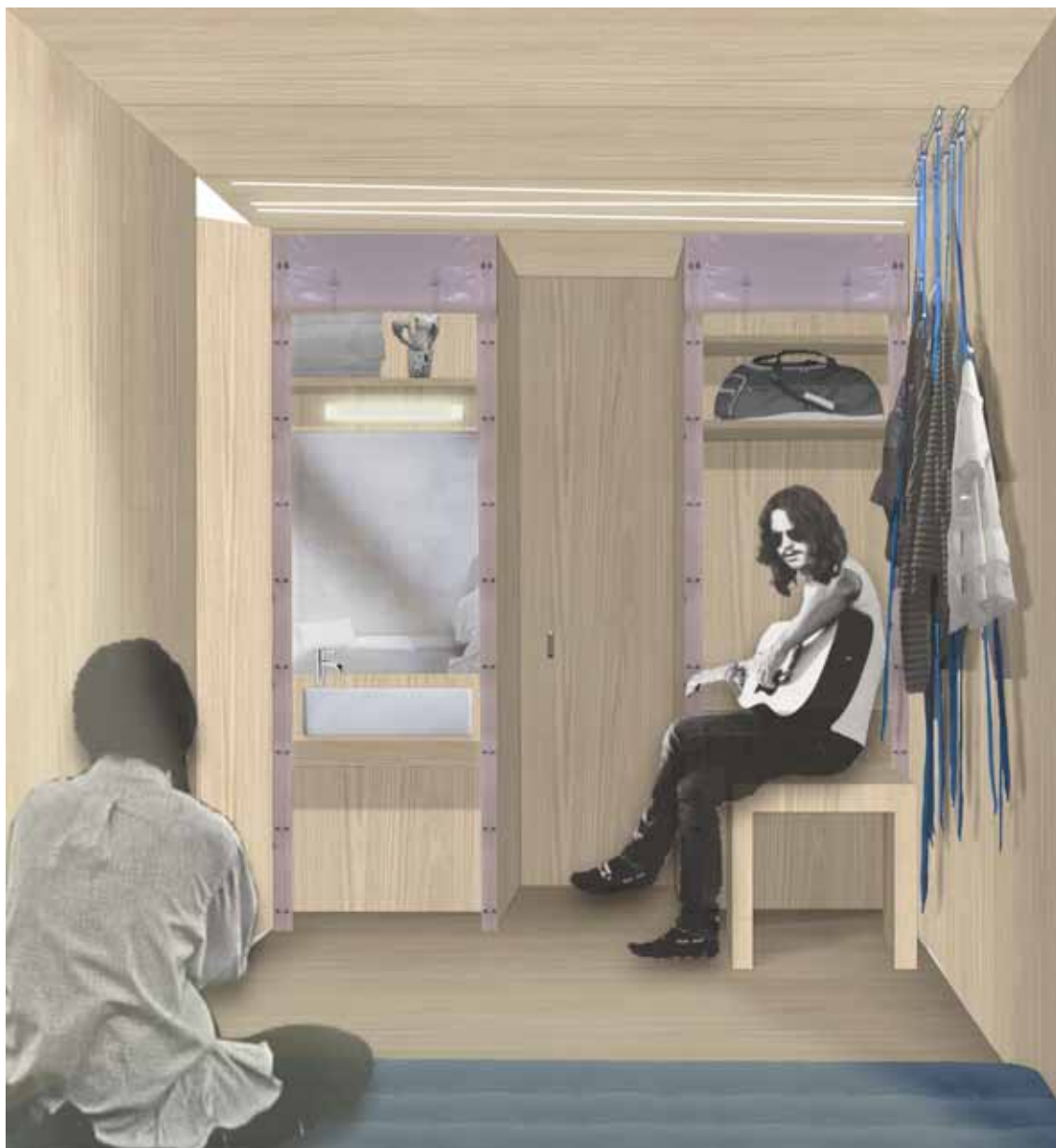

to be continued...